

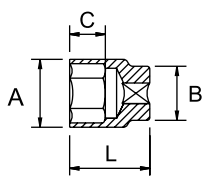
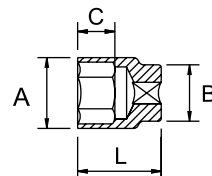

**LLAVES DE VASO / SOCKET WRENCHES / DOUILLES / STECKSCHLÜSSEL
BUSSOLE / CHAVES DE CAIXA / ГОЛОВКИ**

1/4"

MM

COD X								
61311	4mm	6,9		2				
61312	5mm	8,1	12	2,5	10			
61313	6mm	9,4		3,5				
61314	7mm	10,8			12			
61315	8mm	12	11	4				
61316	9mm	13	11,5	5	14	10	1	
61317	10mm	14	12,5	6	18			
61318	11mm	16	13,6	7	22			
61319	12mm	17	14,6	8	24			
61320	13mm	18	16	8	25			
61321	14mm	20	17,5	10	30			

Cr-V DIN 3124

INCH.

COD y								
60420	5/32"	6,9		2				
60421	3/16"	8,1	12	2,5	10			
60422	7/32"	8,8		3				
60423	1/4"	9,9		3,5	12			
60424	9/32"	10,8		4				
60425	5/16"	12	11	5	14	10	1	
60426	11/32"	13	13	5	18			
60427	3/8"	14	14	6	22			
60428	7/16"	16	16	7	24			
60429	1/2"	18	18	8	25			
60430	9/16"	20	20	10	30			

Cr-V DIN 3124
ADAPTADOR / ADAPTER / ADAPTATEUR / VERBINDUNGSTEILE / ADATTATORE / REDUTOR / АДАПТЕР

COD	1/4"			
65880	1/4-3/8"	15	6	1

NEW
**DESTORNILLADOR PORTAVASOS 1/4" / 1/4" SOCKET HOLDER / TOURNEVIS PORTE-DOUILLE 1/4" / 1/4" SOCKET HALTER
CACCIAVITE PORTA BUSSOLA 1/4" / APARAFUSADOR PORTA CHAVES CAIXA 1/4" / 1/4" ДЕРЖАТЕЛЬ ГОЛОВКИ**

COD					
66732	1/4"	190	95	6	1

**LLAVE DE CARRACA REVERSIBLE / REVERSIBLE RATCHET HANDLE / CLE A CLIQUET / UMSCHALTKNARRE
CHIAVE A GRICCO REVERSIBILE / ROQUETE REVERSIVEL / РЕВЕРСИВНАЯ ТРЕЩЕТКА**

COD					
61428	1/4"	140	105	6	1

DIN 3122

**MANGO CORREDIZO EN "T" / SLIDING "T" HANDLE / POIGNEE COULISSANTE / QUERGRIF / ASTA CON QUADRO SCORREVOLO
CAVO "T" CORREDIÇO / ПОДВИЖНАЯ "Т" РУЧКА**

COD					
61438	1/4"	115	60	5	1

DIN 3122

**ARTICULACIÓN UNIVERSAL / UNIVERSAL JOINT / CARDAN UNIVERSEL / KARDANGELENK / SNODO CARDANICO
CARDAN UNIVERSAL / ШАРНИР**

COD					
61435	1/4"	30	10	1	

DIN 3123

ALARGADERA / EXTENSION / RALLONGE / VERLÄNGERUNG / PROLUNGA / EXTENÇÃO / УДЛИНИТЕЛЬ

COD					
61442	2"	53	25	5	1
61444	6"	151	65		

DIN 3123

- x 50% cromado aeroespacial / 50% aerospaceal chrome plating / 50% chromée aérospatiale
50% mirror polished chrome plating / 50% cromado pulido espejo / 50% polie chromée
- y 100% cromado pulido espejo / 100% mirror polished chrome plating / 100% polie chromée

3/8"

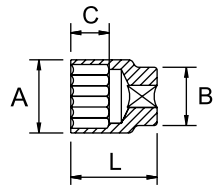

MM

COD X		L	A	B	C	gr.		
61343	8mm	12,2			5	20		
61344	9mm	13,5						
61345	10mm	14,7			6	26		
61346	11mm	16			7			
61347	12mm	17	16					
61348	13mm	18	16,5		8	28		
61349	14mm	20	18					
61350	15mm	21						
61351	16mm	22	20		10	30	10	1
61352	17mm		24	21				
61353	18mm			22		40		
61354	19mm		26					
61355	20mm		27		12	45		
61356	21mm		28	24		50		
61357	22mm		30	26	14	60		

Cr-V DIN 3124

INCH.

COD y		L	A	B	C	gr.		
60439	1/4"	12				20		
60440	5/16"	12,2						
60441	11/32"	13,5			5	20		
60442	3/8"	14,7						
60443	7/16"	16			7	26		
60444	1/2"	18	16,5		8	28		
60445	9/16"	20	18					
60446	19/32"	21			10			
60447	5/8"	22	20			30		
60448	11/16"	24	21					
60449	3/4"	26	22		12	40		
60450	13/16"	28	24			45		
60451	7/8"	30	26	14		60		

Cr-V DIN 3124

ADAPTADOR / ADAPTER / ADAPTATEUR / VERBINDUNGSTEILE / ADATTATORE / REDUTOR / АДАПТЕР

COD	3/8"	gr.		
65884	3/8-1/4"	20		
65881	3/8-1/2"	45	6	1

LLAVES DE VASO PARA BUJÍAS / SPARK PLUG SOCKETS / DOUILLES POUR BOUGIES / ZÜNDKERZEN - STECKSCHLÜSSEL / CHIAVI PER CANDELE CHAVES DE CAIXA PARA VELAS / ГОЛОВКИ ДЛЯ СВЕЧЕЙ ЗАЖИГАНИЯ

COD		A	B	H	L	gr.		
61460	3/8"	16mm	22	19	17	65	98	6
61461	3/8"	21mm	28	22	20	65	150	1

LLAVE DE CARRACA REVERSIBLE / REVERSIBLE RATCHET HANDLE / CLE A CLIQUET / UMSCHALTKNARRE / CHIAVE A CRICCO REVERSIBILE / ROQUETE REVERSIVEL / РЕВЕРСИВНАЯ ТРЕЩЕТКА

COD		L mm	gr.		
61429	3/8"	200	270	6	1

DIN 3122

MANGO CORREDIZO EN "T" / SLIDING "T" HANDLE / POIGNEE COULISSANTE / QUERGRIF / ASTA CON QUADRO SCORREVOLE / CABO "T" CORREDIÇO / ПОДВИЖНАЯ "Т" РУЧКА

COD		L mm	gr.		
61439	3/8"	165	180	5	1

DIN 3122

ARTICULACIÓN UNIVERSAL / UNIVERSAL JOINT / CARDAN UNIVERSEL / KARDANGELENK / SNODO CARDANICO / CARDAN UNIVERSAL / ШАРНИР

COD		gr.		
61436	3/8"	80	10	1

DIN 3123

ALARGADERA / EXTENSION / RALLONGE / VERLÄNGERUNG / PROLUNGA / EXTENÇÃO / УДЛИНИТЕЛЬ

COD		L mm	gr.		
61447	5"	126	120		
61450	10"	248	240	5	1

DIN 3123

- x 50% cromado aeroespacial / 50% aerospaceal chrome plating / 50% chromée aérospatiale
50% mirror polished chrome plating / 50% cromado pulido espejo / 50% polie chromée
- y 100% cromado pulido espejo / 100% mirror polished chrome plating / 100% polie chromée

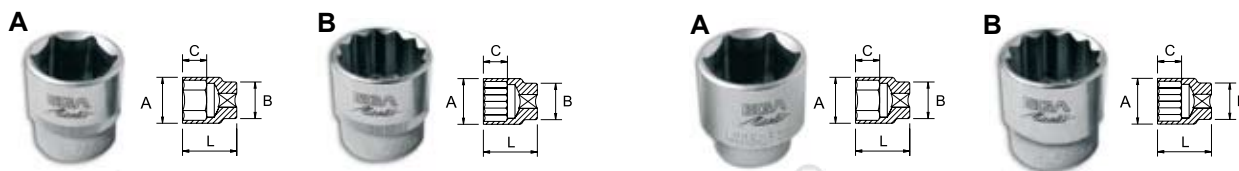
1/2"

MM

COD X				COD X			
gr.	A	L	B	gr.	B	gr.	
40	61800 8mm	13		5	61380	45	
45	61801 9mm	14			61381		
	61802 10mm	15,5		6	61382		
50	61803 11mm	16,7	22	7	61383		
	61804 12mm	18		8	61384	50	
	61805 13mm	19,2			61385		
10	61806 14mm	20,5			61386		
55	61807 15mm	22	20,8	10	61387	55	10
	61808 16mm	24	22		61388		
70	61809 17mm	24	22		61389	60	
90	61810 18mm	26	23,2		61390	80	
80	61811 19mm	26	23,2	12	61391	60	1
95	61812 20mm	28	24		61392	80	
90	61813 21mm	28	24		61393	75	
110	61814 22mm	30		14	61394	85	
105	61815 23mm	32	25		61395	105	
95	61816 24mm	32			61396		
125	61817 25mm	34	27	16	61397	130	
135	61818 26mm	36	28		61398	140	
145	61819 27mm	36	28	18	61399	150	5
155	61820 28mm	38	30		61400	160	
160	61821 29mm	40	31	20	61401	170	
165	61822 30mm	40	31		61402	190	
180	61823 32mm	42	33	22	61403	205	

Cr-V DIN 3124
INCH.

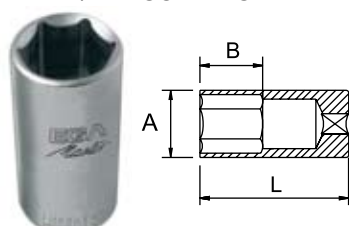
COD y				COD y			
gr.	A	L	B	gr.	B	gr.	
40	60460 5/16"	15,3		5	60480	40	
45	60461 3/8"	14		6	60481	45	
	60462 7/16"	16,7		7	60482		
50	60463 1/2"	19,2	22	8	60483	50	
	60464 9/16"	20,5			60484		
10	60465 19/32"	22		10	60485	55	10
55	60466 5/8"	23	23		60486		
70	60467 11/16"	24	24	11	60479	60	
	60468 3/4"	26	23,2		60487	70	
80	60469 25/32"	28	24	12	60488	80	1
95	60470 13/16"	30			60489	95	
110	60471 7/8"	32	25	14	60491	110	
115	60472 15/16"	34	27		60492	115	
125	60473 31/32"	36	28	16	60493	125	
135	60474 1"	38	30		60494	135	5
145	60475 1.1/16"	40	31	18	60495	145	
155	60476 1.1/8"	42	33	20	60496	155	
165	60477 1.3/16"	44	35		60497	165	
180	60478 1.1/4"	46	37	22	60498	180	

Cr-V DIN 3124
**1/2" SERIE LARGA / LONG SERIE / SERIE LONGUE / LANGE SERIE / SERIE LUNGA
SERIE LONGA / ВЫСОКАЯ СЕРИЯ**

MM

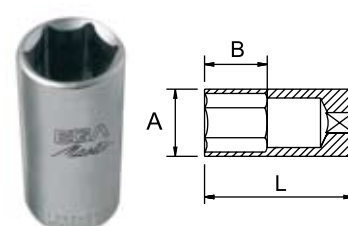
COD X				COD X			
gr.	A	L	B	gr.	B	gr.	
65044	10mm	15,5	9				
65045	11mm	16,7	10,5				
65046	12mm	18					
65047	13mm	19,2	12			90	
65048	14mm	20,5					
65049	15mm	22	15				
65050	16mm	24					
65051	17mm	26				100	10
65052	18mm	28				135	
65053	19mm	30				175	
65054	21mm	32				200	
65055	22mm	34				210	
65056	23mm	36				220	
65057	24mm	38					



Cr-V DIN 3124

INCH.

COD y				COD y			
gr.	A	L	B	gr.	B	gr.	
65064	3/8"	14	6				
65065	7/16"	16,7	7				
65066	1/2"	19,2	8			90	
65067	9/16"	20,5	10				
65068	5/8"	22	15			100	10
65069	11/16"	24				135	
65070	3/4"	26				175	
65071	13/16"	28				200	
65072	7/8"	30				220	
65073	15/16"	32					





Cr-V DIN 3124

- x 50% cromado aeroespacial / 50% aerospace chrome plating / 50% chromée aérospatiale
50% cromado pulido espejo / 50% mirror polished chrome plating / 50% polie chromée
- y 100% cromado pulido espejo / 100% mirror polished chrome plating / 100% polie chromée

ADAPTADOR / ADAPTER / ADAPTATEUR / VERBINDUNGSTEILE / ADATTATORE / REDUTOR / АДАПТЕР

COD	1/2"			
65885	1/2-3/8"	50	6	1
65882	1/2-3/4"	125		





 LLAVES DE VASO PARA BUJÍAS / SPARK PLUG SOCKETS / DOUILLES POUR BOUGIES / ZÜNDKERZEN - STECKSCHLÜSSEL /
CHIAVI PER CANDELE CHAVES DE CAIXA PA VELAS / ГОЛОВКИ ДЛЯ СВЕЧЕЙ ЗАЖИГАНИЯ

COD			A	B	H	L			
61462	1/2"	16mm	22	22	14	65	100	6	1
61463	1/2"	21mm	28	24	16	65	151		

 MANGO ARTICULADO / FLEXIBLE HANDLE / MANCHE ARTICULÉ / FLEXIBLE VERBINDUNG / IMPUGNATURA SNODABILE /
CAVO ARTICULADO / РУЧКА С ШАРНИРОМ

COD			L	
61441	1/2"	0 - 180°	375	650

 MANGO ARTICULADO DE ACCION RAPIDA / QUICK RELEASE FLEXIBLE HANDLE / MANCHE ARTICULÉ ACTION RAPIDE / FLEXIBLE
VERBINDUNG MIT SCHNELLVERSTELLUNG / MANICO SNODABILE AZIONE RAPIDA / CAVO ARTICULADO DE ACÇÃO RÁPIDA
БЫСТРОСЪЕМНАЯ РУЧКА С ШАРНИРОМ



COD		L		
61483	1/2"	430	900	6

 MANGO ARTICULADO TELESCOPICO / TELESCOPIC FLEXIBLE HANDLE / MANCHE ARTICULÉ TÉLESCOPIQUE / TELESKOPISCHE
FLEXIBLE VERBINDUNG / MANICO SNODABILE FLESSIBILE / CAVO ARTICULADO TELESCÓPICO / ТЕЛЕСКОПИЧЕСКАЯ РУЧКА С
ШАРНИРОМ

COD		min	max		
61484	1/2"	430	640	1150	6







ALARGADERA / EXTENSION / RALLONGE / VERLÄNGERUNG / PROLUNGA / EXTENÇÃO / УДЛИНИТЕЛЬ

COD	1/2"	L mm			
61453	3"	76	135	5	1
61455	5"	126	225		
61458	10"	253	375		







DIN 3123

BERBIQUÍ / SPEEDER HANDLE / VILLEBREQUIN / KURBEL / LEVA GIROVECCHINO / MANIVELA / КОЛЕНЧАТАЯ РУЧКА

COD		L mm			
61434	1/2"	410	570	5	1

DIN 3122

 LLAVE DE CARRACA REVERSIBLE / REVERSIBLE RATCHET HANDLE / CLE A CLIQUET / UMSCHALTKNARRE
CHIAVE A CRICCO REVERSIBILE / ROQUETE REVERSIVEL / РЕВЕРСИВНАЯ ТРЕЩЕТКА

COD		L mm			
61430	1/2"	235	575	6	1
61431	1/2"	250	560	6	1

DIN 3122

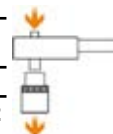

GEARLESS - CARRACA A FRICCIÓN

 MANGO CORREDIZO EN "T" / SLIDING "T" HANDLE / POIGNEE COULISSANTE / QUERGRIF / ASTA CON QUADRO SCORREVOLO
CAVO "T" CORREDIÇO / ПОДВИЖНАЯ "Т" РУЧКА

COD		L mm			
61440	1/2"	250	160	5	1

DIN 3122



 ARTICULACIÓN UNIVERSAL / UNIVERSAL JOINT / CARDAN UNIVERSEL / KARDANGELENK / SNODO CARDANICO CARDAN
UNIVERSAL / ШАРНИР

COD				
61437	1/2"	140	10	1

DIN 3123

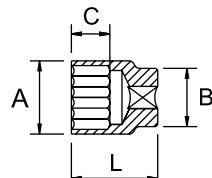
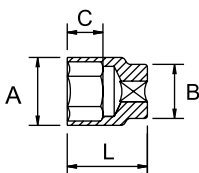

3/4"



MM

COD X		L	A	B	C	gr.		
60501	19mm	50	29,20	33	14	185		
60503	22mm	50	32,20		14	210		
60504	23mm		33,20			220		
60505	24mm	51	34,20			230		
60506	25mm		36	36	16	260		
60507	26mm		37			265		
60508	27mm	52	38			255		
60509	28mm		39		22	265		
60510	29mm		40			275		
60511	30mm	54	42		24	290		
60512	32mm	56	44			320	10	1
60514	34mm		47		26	340		
60515	35mm		48			435		
60516	36mm	58	50	42		430		
60517	38mm	60	52		28	460		
60519	41mm	64	56	45	30	575		
60520	42mm		57			560		
60521	46mm	68	62	47	34	750		
60522	50mm	72	68		36	835		
60523	55mm	76	74	48	40	1150		
60524	60mm	78	80		42	1180		

Cr-V DIN 3124

INCH.

COD y		L	A	B	C	gr.		
60527	7/8"	50	32,20		14	200		
60528	15/16"	51	34,20		16	210		
60529	1"		37			250		
60530	1.1/16"	52	38		22	255		
60531	1.1/8"		40			310		
60532	1.1/4"	56	44	38	24	310		
60533	1.5/16"		46		26	325		
60534	1.3/8"	58	48	42	28	410	10	1
60535	1.7/16"		50			420		
60536	1.1/2"	60	52		30	460		
60537	1.5/8"	64	56	45	32	505		
60538	1.11/16"	65	58			570		
60539	1.13/16"	68	62	47	34	730		
60540	1.7/8"	70	64	48	36	760		
60541	2"	72	68			780		

Cr-V DIN 3124

ADAPTADOR / ADAPTER / ADAPTATEUR / VERBINDUNGSTEILE / ADATTATORE / REDUTOR / АДАПТЕР

COD	1/2"	gr.		
65883	3/4-1"	250	6	1
65886	3/4-1/2"	136		

LLAVE DE CARRACA REVERSIBLE / REVERSIBLE RATCHET HANDLE / CLÉ À CLIQUET / UMSCHALTKNARRE
CHIAVE A CRICCO REVERSIBILE / ROQUETE REVERSIVEL / РЕВЕРСИВНАЯ ТРЕЩЕТКА

COD	3/4"	mm	gr.		
61863	3/4"	498	2260	6	1

DIN 3122

MANGO ARTICULADO / FLEXIBLE HANDLE / MANCHE ARTICULÉ / FLEXIBLE VERBINDUNG / IMPUGNATURA SNODABILE /
CABO ARTICULADO / РУЧКА С ШАРНИРОМ

COD	3/4"	mm	Kg.		
61473	3/4"	1000	3,75		
61456	3/4"	485	1,9	6	

MANGO CORREDIZO EN "T" / SLIDING "T" HANDLE / POIGNEE COULISSANTE / QUERGRIF / ASTA CON QUADRO SCORREVOLO
CABO "T" CORREDIÇO / ПОДВИЖНАЯ "Т" РУЧКА

COD	3/4"	mm	gr.		
61864	3/4"	450	1210	5	1

DIN 3122

ARTICULACIÓN UNIVERSAL / UNIVERSAL JOINT / CARDAN UNIVERSEL / KARDANGELENK / SNODO CARDANICO CARDAN
UNIVERSAL / ШАРНИР

COD	3/4"	gr.			
61860	3/4"	600	6	1	

DIN 3123



ALARGADERA / EXTENSION / RALLONGE / VERLÄNGERUNG / PROLUNGA / EXTENÇÃO / УДЛИНИТЕЛЬ

COD	3/4"	mm	gr.		
61865	4"	105	410	5	1
61866	8"	203	720		

DIN 3123



- x 50% cromado aeroespacial / 50% aerospace chrome plating / 50% chromée aérospatiale
50% cromado pulido espejo / 50% mirror polished chrome plating / 50% polie chromée
- y 100% cromado pulido espejo / 100% mirror polished chrome plating / 100% polie chromée

1"

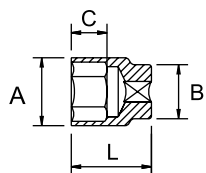

MM

COD X		L	A	B	C	gr.		
65001	36mm	65	51	45	28	530		
65002	41mm	70	57		32	630		
65003	46mm		65	50		750		
65004	50mm	75	70	55	34	885		
65005	54mm		74			1035		
65006	55mm	80	76		40	1180		
65007	58mm		79			1280		
65008	60mm	84	82	57	42	1355		
65009	63mm		86			1600		
65010	65mm	87	88		44	1600		
65011	67mm	90	90		46	1730		
65012	70mm		94		48	1980		
65013	71mm	93	95					
65014	75mm	97	100	68	52	2250		
65015	77mm		102			2400		
65016	80mm	103	105		54	2500		

Cr-V DIN 3124

INCH.

COD X		L	A	B	C	gr.		
65022	1.5/8"		57	45	32	630		
65023	1.13/16"	70	65	50		750		
65024	1.7/8"		67		34	775		
65025	2"	75	70			885		
65026	2.1/8"		74			1035		
65027	2.3/16"		76			1180		
65028	2.1/4"	80	78	57	40	1290		
65029	2.3/8"		82		42	1355		
65030	2.1/2"	84	86			1600		
65031	2.5/8"	87	88		44	1730		
65032	2.3/4"	90	90		48	1980		
65033	3"	93	94		54	2470		
65034	3.1/8"	103	102	68		2500		

Cr-V DIN 3124

ADAPTADOR / ADAPTER / ADAPTATEUR / VERBINDUNGSTEILE / ADATTATORE / REDUTOR / АДАПТЕР

COD	1"	gr.		
65040	1-3/4"	435	6	1

MANGO ARTICULADO / FLEXIBLE HANDLE / MANCHE ARTICULÉ / FLEXIBLE VERBINDUNG / IMPUGNATURA SNODABILE /
CABO ARTICULADO / РУЧКА С ШАРНИРОМ

COD		L	Kg.	
61474	1"	1000	4	6
61457	1"	650	2,5	6

LLAVE DE CARRADA REVERSIBLE / REVERSIBLE RATCHET HANDLE / CLE A CLIQUET / UMSCHALTKNARRE
CHIAVE A CRICCO REVERSIBILE / ROQUETE REVERSIVEL / РЕВЕРСИВНАЯ ТРЕЩЕТКА

COD		L mm	gr.	
65035	1"	670	4410	1

MANGO CORREDIZO EN "T" / SLIDING "T" HANDLE / POIGNEE COULISSANTE / QUERGRIF / ASTA CON QUADRO SCORREVOLO
CABO "T" CORREDIÇO / ПОДВИЖНАЯ "Т" РУЧКА

COD		L mm	gr.		
65036	1"	560	3295	2	1

DIN 3122

ARTICULACIÓN UNIVERSAL / UNIVERSAL JOINT / CARDAN UNIVERSEL / KARDANGELENK / SNODO CARDANICO
CARDAN UNIVERSAL / ШАРНИР

COD		L mm	gr.		
65039	1"	1215	6	1	

DIN 3123



ALARGADERA / EXTENSION / RALLONGE / VERLÄNGERUNG / PROLUNGA / EXTENÇÃO / УДЛИНИТЕЛЬ

COD	1"	L mm	gr.		
65037	8"	205	1170	5	1
65038	16"	405	2300		

DIN 3123



x

50% cromado aeroespacial / 50% aerospaceal chrome plating / 50% chromée aérospatiale
50% cromado pulido espejo / 50% mirror polished chrome plating / 50% polie chromée





KITS - SETS
1/4"
29 PCS.

COD		Kg.
61958	4-5-6-7-8-9-10-11-12-13-14mm	0,85
61961	5/32"-3/16"-7/32"-1/4"-9/32"	
	5/16"-11/32"-3/8"-7/16"-1/2"-9/16"	

Carraca / Ratchet / Crécelle		●
Alargadera / Extensión / Rallonge		2"-6"
Mango en T / T Handle / T Poignee		●
Articulación universal / Universal Joint Cardan Universel		●
Punta hexagonal con vaso / Hex bit socket Embout hexagonal á douille		3-4-5-6-8
Punta plana con vaso / Flat bit socket Embout fente á douille		4x0,6 - 5,5x1 - 7x1,2
Punta Philips con vaso / Philips bit socket Embout Philips á douille		PH1-PH2-PH3-PH4
Destornillador portavasos / Socket holder Tournevis porte douille		●



24 PCS.

COD		Kg.
61791	4-5-6-7-8-9-10-11-12-13mm	0,8
	3/16"-7/32"-1/4"-9/32"- 5/16"-11/32"-3/8"-7/16"-1/2"	

Carraca / Ratchet / Crécelle		●
Alargadera / Extensión / Rallonge		2"
Articulación universal / Universal Joint Cardan Universel		●
Mango articulado / Flexible handle Manche articulé		●
Destornillador portavasos / Socket holder Tournevis porte douille		●

11 PCS.

COD		Kg.
61323	4-5-6-7-8-9-10-11-12-13-14mm	0,4
61324	5/32"-3/16"-7/32"-1/4"-9/32"	
	5/16"-11/32"-3/8"-7/16"-1/2"-9/16"	



Carraca / Ratchet / Crécelle		●
--	---	---







KITS - SETS

3/8"



16 PCS.





COD		
61959	8-10-11-12-13-14-15-17-19-21-22 mm	1,7
61962	5/16"-3/8"-7/16"-1/2"-9/16"-19/32"	
	5/8"-11/16"-3/4"-13/16"-7/8"	

Carraca / Ratchet / Crécelle		●
Alargadera / Extensión / Rallonge		5"-10"
Mango en T / T Handle / T Poignee		●
Articulación universal / Universal Joint Cardan Universel		●





42 PCS.

42 PCS.				
COD			Serie larga Long serie Serie Longue	
61792	9-10-11-12-13-14-15-16-17-18-19 mm	9-10-11-12-13-14-15-16-17-18-19 mm		5
	3/8"-7/16"-1/2"-9/16"-5/8"-11/16"-3/4"	3/8"-7/16"-1/2"-9/16"-5/8"-11/16"-3/4"		



Carraca / Ratchet / Crécelle		●
Alargadera / Extensión / Rallonge		3"-6"-8"
Articulación universal / Universal Joint Cardan Universel		●
Mango articulado / Flexible handle Manche articulé		●



16 PCS.

COD		
61341	8-9-10-11-12-13-14-15-16-17-18-19-20-21-22mm	1
Carraca / Ratchet / Crécelle		●

13 PCS.

COD		
61342	5/16"-11/32"-3/8"-7/16"-1/2"-9/16"-19/32" 5/8"-11/16"-3/4"-13/16"-7/8"	0,9
Carraca / Ratchet / Crécelle		●



KITS - SETS
1/2"
25 PCS.

COD		Kg.
61960	10-11-12-13-14-15-16-17-18-19-20-21-22-23-24-26-27-28-30-32mm	4,25
61963	5/16"-3/8"-7/16"-1/2"-9/16"-19/32"-5/8"-21/32"-11/16"-3/4"-25/32"-13/16"-7/8"-15/16"-31/32"-1"-1.1/16"-1.1/8"-1.3/16"-1.1/4"	
Carraca / Ratchet / Crécelle		●
Alargadera / Extensión / Rallonge		5"-10"
Mango en T / T Handle / T Poignee		●
Articulación universal / Universal Joint Cardan Universel		●

17 PCS.

COD		Kg.
61796	10-11-12-13-14-15-16-17-18-19-20-22-24-27-30-32mm	2,05
61798	5/16"-3/8"-7/16"-1/2"-9/16"-5/8"-11/16"-3/4"-13/16"-7/8"-15/16"-1"-1.1/16"-1.1/8"-1.3/16"-1.1/4"	
61797	10-11-12-13-14-15-16-17-18-19-20-22-24-27-30-32mm	2,05
61799	5/16"-3/8"-7/16"-1/2"-9/16"-5/8"-11/16"-3/4"-13/16"-7/8"-15/16"-1"-1.1/16"-1.1/8"-1.3/16"-1.1/4"	
Carraca / Ratchet / Crécelle		●

41 PCS.

COD		Kg.
61793	10-11-12-13-14-15-16-17-18-19-20-21-22-23-24-27-30-32mm 3/8"-7/16"-1/2"-9/16"-5/8"-11/16"-3/4"-13/16"-7/8"-15/16"-1"-1.1/16" 1.1/8"-1.3/16"-1.1/4"	5,5
Carraca / Ratchet / Crécelle		●
Alargadera / Extensión / Rallonge		6"-8"
Mango en T / T Handle / T Poignee		●
Articulación universal / Universal Joint Cardan Universel		●
Mango articulado / Flexible handle Manche articulé		●
Vasos para bujías / Spark plug sockets Douille à bougie		16-21mm

33 PCS.

COD		Serie larga Long serie Serie Longue	Kg.
65074	10-11-12-13-14-15-16-17-18-19-20-21-22-23-24mm	10-11-12-13-14-15-16-17-18-19mm	7
65075	3/8"-7/16"-1/2"-9/16"-5/8"-11/16" 3/4"-13/16"-7/8"-15/16"-1" 1.1/16"-1.1/8"-1.3/16"-1.1/4"	3/8"-7/16"-1/2"-9/16"-5/8"-11/16"-3/4"-3/16"-7/8"-15/16"	
Carraca / Ratchet / Crécelle		●	
Alargadera / Extensión / Rallonge		3"-5"-10"	
Mango articulado / Flexible handle Manche articulé		●	
Articulación universal / Universal Joint Cardan Universel		●	
Vasos para bujías / Spark plug sockets Douille à bougie		16-21mm(65074) 5/8"-13/16"(65075)	



EXPOSITORES / DISPLAYS / PRESENTOIRS / STÄNDER / ESPOSITORE / DISPLAY STAND / СТЕНДЫ
1/2" 233 PCS. 1/2" 236 PCS.

UN.	COD:65296	UN.	COD:65297	UN.	COD:65298	UN.	COD:65299
	8mm		8mm		5/16"		5/16"
	9mm		9mm	24	3/8"	24	3/8"
	10mm		10mm		7/16"		7/16"
12	11mm	12	11mm	12	1/22	12	1/22
	12mm		12mm	24	9/16"		9/16"
	13mm		13mm	22	5/8"		19/32"
	14mm		14mm	20	11/16"	11	5/8"
	15mm		15mm	19	3/4"		21/32"
11	16mm	11	16mm	9	13/16"	20	11/16"
	17mm		17mm	16	7/8"	10	3/4"
10	18mm	10	18mm	8	15/16"	9	25/32"
	19mm		19mm	14	1"		13/16"
9	20mm	9	20mm		1.1/16"	16	7/8"
	21mm		21mm	7	1.1/8"	8	15/16"
	22mm		22mm		1.3/16"		31/32"
8	23mm	8	23mm	6	1.1/4"	7	1"
	24mm		24mm				1.1/16"
	25mm		25mm				1.1/8"
7	26mm	7	26mm				1.3/16"
	27mm		27mm				1.1/4"
	28mm		28mm				
	29mm		29mm				
	30mm		30mm				
6	32mm	6	32mm				



A: 61430
B: 61431

3/4"

15 PCS.

mm = inch. =

COD	C				Kg.
61861	22-24-27-30-32-36-38-41-46-50	4"			
61862	7/8"-15/16"-1"-1.1/8"-1.1/4"-1.7/16"-1.1/2"-1.5/8"-1.13/16"-2"	8"			12,5



EXPOSITORES / DISPLAYS / PRESENTOIRS / STÄNDER / ESPOSITORE / DISPLAY STAND / СТЕНДЫ
86 PCS. 86 PCS.

UN.	COD:65300	UN.	COD:65301
	19mm	14	7/8"
	22mm		15/16"
7	24mm	7	1"
	26mm		1.1/16"
	27mm	6	1.1/8"
6	29mm	12	1.1/4"
	30mm		1.5/16"
	32mm		1.3/8"
	34mm	5	1.7/16"
	35mm		1.1/2"
5	36mm		1.5/8"
	38mm	4	1.13/16"
	41mm		2"
4	46mm		
	50mm		



1"

15 PCS.

mm = inch. =

COD	C				Kg.
65041	36-41-46-50-55-60-65-70-75-80	8"			
65042	1.13/16"-1.7/8"-2"-2.3/16"-2.1/4"-2.3/8"-2.1/2"-2.5/8"-2.3/4"-3.1/8"	16"			27



LLAVES DE VASO DE IMPACTO / IMPACT SOCKET WRENCHES / DOUILLES A CHOC
KRAFTSCHRAUBEREINSATZ / BUSSOLA AD IMPULSI / CHAVES DE CAIXA DE IMPACTO
УДАРНЫЕ ГОЛОВКИ

3/8"

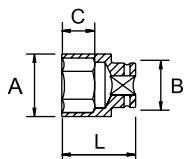

MM

COD		L	A	B	C	gr.		
60590	7mm		12			41		
60591	8mm		13					
60592	9mm		14			43		
60593	10mm		16	19	14			
60594	11mm		17			44		
60595	12mm		18					
60596	13mm	30	20	20	15		6	1
60597	14mm		21	21		60		
60598	15mm		22	22				
60599	16mm		23	23	16			
60600	17mm		24	24		62		
60601	18mm		26	26				
60602	19mm		27	27		72		

Cr-V DIN 3129

INCH.

COD		L	A	B	C	gr.		
65205	5/16"		13			43		
65206	3/8"		15			44		
65207	7/16"		17	19	14			
65208	1/2"		19		15	60	6	1
65209	9/16"	30	21	21				
65210	5/8"		23	23	16	62		
65211	11/16"		25	25		72		
65212	3/4"		27	27				

Cr-V DIN 3129

1/2"

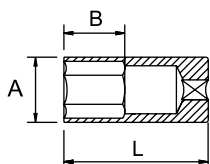

MM

COD		L	A	B	gr.		
60603	10mm		17				
60604	11mm		18				
60605	12mm		19			86	
60606	13mm		20	14			
60607	14mm		22			106	
60608	15mm		23				
60609	16mm		24				
60610	17mm		26				
60611	18mm	38	27	15		127	6
60612	19mm		28				
60639	20mm		29	19			
60613	21mm		31				
60614	22mm		32	20		132	
60615	24mm		34			137	
60616	27mm		38			171	
60617	29mm		40			190	
60618	30mm		42	21		196	
60619	32mm		44			205	

Cr-V DIN 3129

INCH.

COD		L	A	B	C	gr.		
65213	3/8"		16					
65214	7/16"		18					
65215	1/2"		20	23	14	86		
65216	9/16"		22					
65217	5/8"		24	24	15			
65218	11/16"		26	26	16	127		
65219	3/4"	38	28	28	19		6	1
65220	13/16"		30	30				
65221	7/8"		32	32	20	132		
65222	15/16"		34	34		137		
65223	1"		36			145		
65224	1.1/16"		38			171		
65225	1.1/8"		40	35	21	190		
65226	1.1/4"		44			205		

Cr-V DIN 3129

LLAVES DE VASO DE IMPACTO / IMPACT SOCKET WRENCHES / DOUILLES A CHOC
 KRAFTSCHRAUBEREINSATZ / BUSSOLA AD IMPULSI / CHAVES DE CAIXA DE IMPACTO
 УДАРНЫЕ ГОЛОВКИ

SERIE LARGA / LONG SERIE / SERIE LONGUE / LANGE SERIE / SERIE LUNGA / SERIE LONGA
 ВЫСОКАЯ СЕРИЯ

1/2"

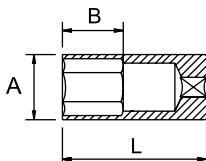



MM

COD























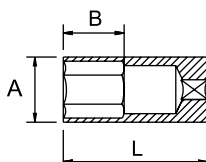

60660	10mm	78	17	27	190	6	1		
60661	11mm		18						
60662	12mm		19						
60663	13mm		20						
60664	14mm		22						
60665	16mm		24	37	263				
60666	17mm		26						
60667	18mm		27						
60668	19mm		28						
60669	21mm		31						
60670	22mm	90	32		310	1	1		
60671	23mm		33		320				
60672	24mm		34		340				
60673	27mm		38		405				
60674	29mm		40		425				
60675	30mm		42		435				
60676	32mm		44		450				

Cr-Mo DIN 3129

3/4"



MM										
COD										
60679	19mm	90	33	28	630	1	1			
60680	21mm		35							
60681	22mm		37							
60682	24mm		39							
60683	26mm		41,5	36	655					
60684	27mm		42,5	53						
60685	30mm		46,5	54						
60686	32mm		49	56	835					
60687	33mm		50,5	58	885					
60688	34mm		51,5		915					
60689	36mm	54	935							
60690	38mm	56,5	940							
60691	41mm	60	950							

Cr-Mo DIN 3129

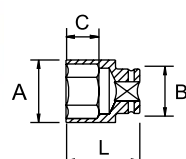
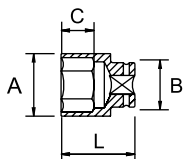
**LLAVES DE VASO DE IMPACTO / IMPACT SOCKET WRENCHES / DOUILLES A CHOC
KRAFTSCHRAUBEREINSATZ / BUSSOLA AD IMPULSI / CHAVES DE CAIXA DE IMPACTO
УДАРНЫЕ ГОЛОВКИ**
3/4"

MM

COD		L	A	B	C	gr.		
60620	19mm		33					
60621	21mm		35					
60622	22mm	50	37					
60623	23mm		38					
60624	24mm		39		22		235	
60625	26mm		41		24			
60626	27mm		43		26			
60627	28mm	53	44					
60628	29mm		45				310	
60629	30mm		46				422	1
60630	32mm		49				436	
60631	33mm	56	51				462	
60632	34mm		51		27		485	
60633	36mm		54				502	
60634	38mm		56				565	
60635	41mm	57	60				600	
60636	42mm		61				690	
60637	46mm	62	66				700	
60638	50mm	72	71	54	28		1085	

Cr-Mo DIN 3129
INCH.

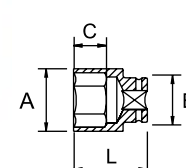
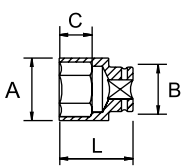
COD		L	A	B	C	gr.		
65227	3/4"		33					
65228	13/16"		35					
65229	7/8"	50	37					
65230	15/16"		39					
65231	1"		41		22		235	
65232	1.1/16"		43		26			
65233	1.1/8"	53	45				310	
65234	1.3/16"		46				422	
65235	1.1/4"		49				436	
65236	1.5/16"	56	51				462	1
65237	1.3/8"		53		27		485	
65238	1.7/16"		55				502	
65239	1.1/2"	57	56				565	
65240	1.5/8"		60				600	
65241	1.11/16"	62	63				690	
65242	1.3/4"		65				700	
65243	1.7/8"	67	69		28		750	
65244	2"	72	73	54			1085	

Cr-Mo DIN 3129
1"

MM

COD		L	A	B	C	gr.		
65534	24mm	61	42				525	
65535	27mm		45				545	
65536	30mm	63	49				565	
65537	32mm		51				600	
65538	36mm		55				685	
60640	38mm	65	59				805	
60641	41mm		63				840	
60642	42mm	68	64				860	
60643	46mm		69				1000	
60644	50mm	74	74				1050	
60645	52mm	80	77				1090	1
60646	54mm		79				1125	
60647	55mm		81				1220	
60648	56mm		82				1270	
60649	57mm	85	83				1300	
60650	58mm		85				1350	
60651	60mm		87				1440	
60652	62mm	89	89				1450	
60653	63mm		91				1540	
60654	65mm	93	93				1550	
60655	70mm	98	99				1710	
60656	75mm	100	106	100	53		3600	

Cr-Mo DIN 3129
INCH.

COD		L	A	B	C	gr.		
65253	1"		44				26	550
65254	1.1/16"	58	46					560
65255	1.1/8"		48					600
65256	1.3/16"	60	49					670
65257	1.1/4"		52				27	710
65258	1.5/16"	61	54					750
65259	1.3/8"		56					770
65260	1.7/16"		58					800
65261	1.1/2"	65	59					805
65262	1.9/16"		62					830
65263	1.5/8"		63				28	840
65264	1.11/16"	68	66					870
65265	1.3/4"		68					900
65266	1.13/16"		69					950
65267	1.7/8"	74	72				32	1000
65268	2"		76					1050
65269	2.1/8"	80	79					1150
65270	2.1/4"	85	83					1300
65271	2.3/8"		87					1450
65272	2.1/2"	89	91				47	1500
65273	2.5/8"	93	96					1600

Cr-Mo DIN 3129



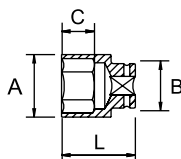



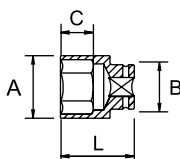

LLAVES DE VASO DE IMPACTO / IMPACT SOCKET WRENCHES / DOUILLES A CHOC
KRAFTSCHRAUBEREINSATZ / BUSSOLA AD IMPULSI / CHAVES DE CAIXA DE IMPACTO
УДАРНЫЕ ГОЛОВКИ

1.1/2"

COD		L	A	B	C	Kg.		
65666	35mm	80	62	86	31	1,8	1	-
65426	46mm	84	74			2,3		
65427	50mm		79			2,5		
65428	55mm		86		32	2,9		
65429	60mm	90	92			3,2		
65430	65mm	95	97		35	3,7		
65431	70mm	100	103		36	4		
65432	75mm	105	108		40	4,5		
65433	80mm	110	115			5,5		
65434	85mm		122			5,7		
65435	90mm	112	128		41	6,5		
65436	95mm		135		42	7,5		
65437	100mm	115	140			7,8		
65438	105mm	120	146			8,6		
65439	110mm	124	153			9,8		
65440	115mm	128	160			10		
65441	120mm	132	166			10,4		
65442	125mm	136	173			11		
65443	130mm	140	180			11,3		
65444	135mm	145	186		53	11,8		
65445	140mm		190		55	12,5		
65446	145mm	150	196		56	14		
65447	150mm	155	200					



Cr-Mo DIN 3129
2.1/2"

MM

COD								
65452	70mm	125	110	128	36	7,6	1	-
65453	75mm		118		40			
65454	80mm	124	41					
65455	85mm	128			8			
65456	90mm	135	42					
65457	95mm	138			9			
65458	100mm	146	44					
65459	105mm	146	155		45			
65460	110mm	155	158		46			
65461	115mm	158	167		48			
65462	120mm	160	175		49			
65463	125mm	165	180		51			
65464	130mm	169	185		53			
65465	135mm	175	188		55			
65466	140mm	180	200		56			
65467	145mm	183	205		58			
65468	150mm	192	208		59			
65469	155mm	195	215		62			
65470	160mm	200	225		63			
65471	165mm	204	228		64			
65472	170mm	207	235		65			
65473	175mm	211	240		66			
65474	180mm	217	248		67			
65475	185mm	218	255		68			
65476	190mm	220	265		20			
65477	200mm	225	275					





Cr-Mo DIN 3129

ADAPTADOR / ADAPTER / ADAPTATEUR / VERBINDUNGSTEILE / ADATTATORE / REDUTOR / АДАПТЕР

COD	3/8"	1/2"	3/4"	1"	1.1/2"	2.1/2"			
60696	3/8-1/2"	-	-	-	-	-	50	6	1
60698	-	1/2-3/8"	-	-	-	-	110		
60699	-	1/2-3/4"	-	-	-	-	130		
60700	-	-	3/4-1/2"	-	-	-	370		
60701	-	-	3/4-1"	-	-	-	410		
60702	-	-	-	1-3/4"	-	-	600		
65448	-	-	-	-	1.1/2"-1"	-	2100		
65449	-	-	-	-	1.1/2"2.1/2"	-	4000		
65478	-	-	-	-	-	2.1/2"-1.1/2"	4500		



DIN 3121

**ARTICULACIÓN UNIVERSAL / UNIVERSAL JOINT / CARDAN UNIVERSEL / KARDANGELENK / SNODO CARDANICO
CARDAN UNIVERSAL / ШАРНИР**

COD				
60704	3/8"	80	6	1
60705	1/2"	180		
60706	3/4"	600		
60707	1"	1245		



DIN 3121

ALARGADERA / EXTENSION / RALLONGE / VERLÄNGERUNG / PROLUNGA / EXTENÇÃO / УДЛИНИТЕЛЬ



COD	3/8"	1/2"	3/4"	1"	1.1/2"			
60710	75	-	-	-	-	80	6	1
60711	-	125	-	-	-	220		
60714	-	-	175	-	-	850		
60716	-	-	-	175	-	1510		
60717	-	-	-	330	-	2575		
65450	-	-	-	-	250	5500		
65451	-	-	-	-	300	6500		

DIN 3121

**ANILLA DE SEGURIDAD / SECURITY O-RING / BAGUES DE SECURITE / SICHERUNGSRING / ANELLO SPACCATO
ANEL DE SEGURANÇA / БЕЗОПАСНОЕ КОЛЬЦО**

COD	3/4"	1"			
60724	19-46	-	5	6	1
60725	50	-			
60726	-	38-70	10		
60727	-	75			

**PASADOR DE SEGURIDAD / SECURITY PIN / GOUPIILLE DE SECURITE / SICHERUNGSSTIFT / COPPIGLIA / PINO DE SEGURANÇA
ФИКСИРУЮЩИЙ ПАЛЕЦ**

COD	3/4"	1"			
60732	19-46	-	10	6	1
60733	50	-			
60734	-	38-70			
60735	-	75	15		



JUEGOS / SETS / COFRETS / SÄTZE / ASSORTIMENTI / JOGOS / НАБОРЫ

1/2" MM

COD	pcs.		Kg.
60693	10	13-14-16-17-19-21-22-24-27-30	3,5
61265		10-11-12-13-14-17-19-21-22-24	3

 SERIE LARGA / LONG SERIE / SERIE LONGUE / LANGE SERIE / SERIE LUNGA
 SERIE LONGA / ВЫСОКАЯ СЕРИЯ

COD	pcs.		Kg.
61266	10	10-11-12-13-14-17-19-21-22-24	4

3/4" MM

COD	pcs.		Kg.
60694	8	26-27-29-30-32-34-36-38	5,1
61269		21-22-24-27-30-32-36-41	4,8

 SERIE LARGA / LONG SERIE / SERIE LONGUE / LANGE SERIE / SERIE LUNGA
 SERIE LONGA / ВЫСОКАЯ СЕРИЯ

COD	pcs.		Kg.
61270	8	21-22-24-27-30-32-36-41	5,8

1" MM

COD	pcs.		Kg.
61273	9	24-27-30-32-36-38-41-46-50	7,5

 SERIE LARGA / LONG SERIE / SERIE LONGUE / LANGE SERIE / SERIE LUNGA
 SERIE LONGA / ВЫСОКАЯ СЕРИЯ

COD	pcs.		Kg.
61274	9	24-27-30-32-36-38-41-46-50	7,5



JUEGOS / SETS / COFRETS / SÄTZE / ASSORTIMENTI / JOGOS / НАБОРЫ

1/2" INCH

COD	pcs.		Kg.
61267	11	3/8"-7/16"-1/2"-9/16"-5/8"-11/16"-3/4"-13/16"-7/8"-15/16"-1"	3,2

 SERIE LARGA / LONG SERIE / SERIE LONGUE / LANGE SERIE / SERIE LUNGA
SERIE LONGA / ВЫСОКАЯ СЕРИЯ

COD	pcs.		Kg.
61268	11	3/8"-7/16"-1/2"-9/16"-5/8"-11/16"-3/4"-13/16"-7/8"-15/16"-1"	4,2

3/4" INCH

COD	pcs.		Kg.
61271	8	1"-1.1/16"-1.1/8"-1.1/4"-1.5/16"-1.3/8"-1.7/16"-1.1/2"	5

 SERIE LARGA / LONG SERIE / SERIE LONGUE / LANGE SERIE / SERIE LUNGA
SERIE LONGA / ВЫСОКАЯ СЕРИЯ

COD	pcs.		Kg.
61272	8	1"-1.1/16"-1.1/8"-1.1/4"-1.5/16"-1.3/8"-1.7/16"-1.1/2"	6

1" INCH

COD	pcs.		Kg.
61275	9	1"-1.1/8"-1.1/4"-1.5/16"-1.1/2"-1.5/8"-1.3/4"-1.7/8"-2"	7,6

 SERIE LARGA / LONG SERIE / SERIE LONGUE / LANGE SERIE / SERIE LUNGA
SERIE LONGA / ВЫСОКАЯ СЕРИЯ

COD	pcs.		Kg.
61276	9	1"-1.1/8"-1.1/4"-1.5/16"-1.1/2"-1.5/8"-1.3/4"-1.7/8"-2"	7,6

